

KEY TO SYMBOLS:

- Existing 220mm CLH Oil Pipeline with 3m wide easements either side of pipeline
- Existing Byway 18
- Existing High Voltage Overhead (OH) Cables. Any existing OH cables that conflict with the proposed NMRES alignment shall be grounded with the provision of a 12m easement. Refer to Triconnex design pack for proposals
- Existing Highway Boundary
- Site Boundary
- Proposed red carriageway surfacing
- Proposed Swale
- Proposed 1:3 highway embankment
- Indicative extent of offsite highway works outside of the NMRE Reserved Matters application

DRAWING REFERENCES:

1. Site redline boundary, received by Cooper Baillie, January 2018
2. Highway boundary based on PDF received by WBC, August, 2017 (reference not provided)
3. OS Data: © crown copyright and database rights 2016. Ordnance Survey, Licence Number AL10001776.
4. Topography produced by Brunel Surveys Ltd, received January 2018 (reference not provided).
5. Northern NMRE Extents and Boundary produced by AECOM, obtained via WBC, November, 2017 (reference: 60312043/CIV/NMRE/002)

KEY TO ENGINEERING NOTES:

- Junction Visibility Tangent based on Manual for Streets (x=2.4m, y=43m)
- 90m minimum Sight Stopping distance to proposed crossing facility in accordance to DMRB TD50 /04 & TD 9 (6.1.1)

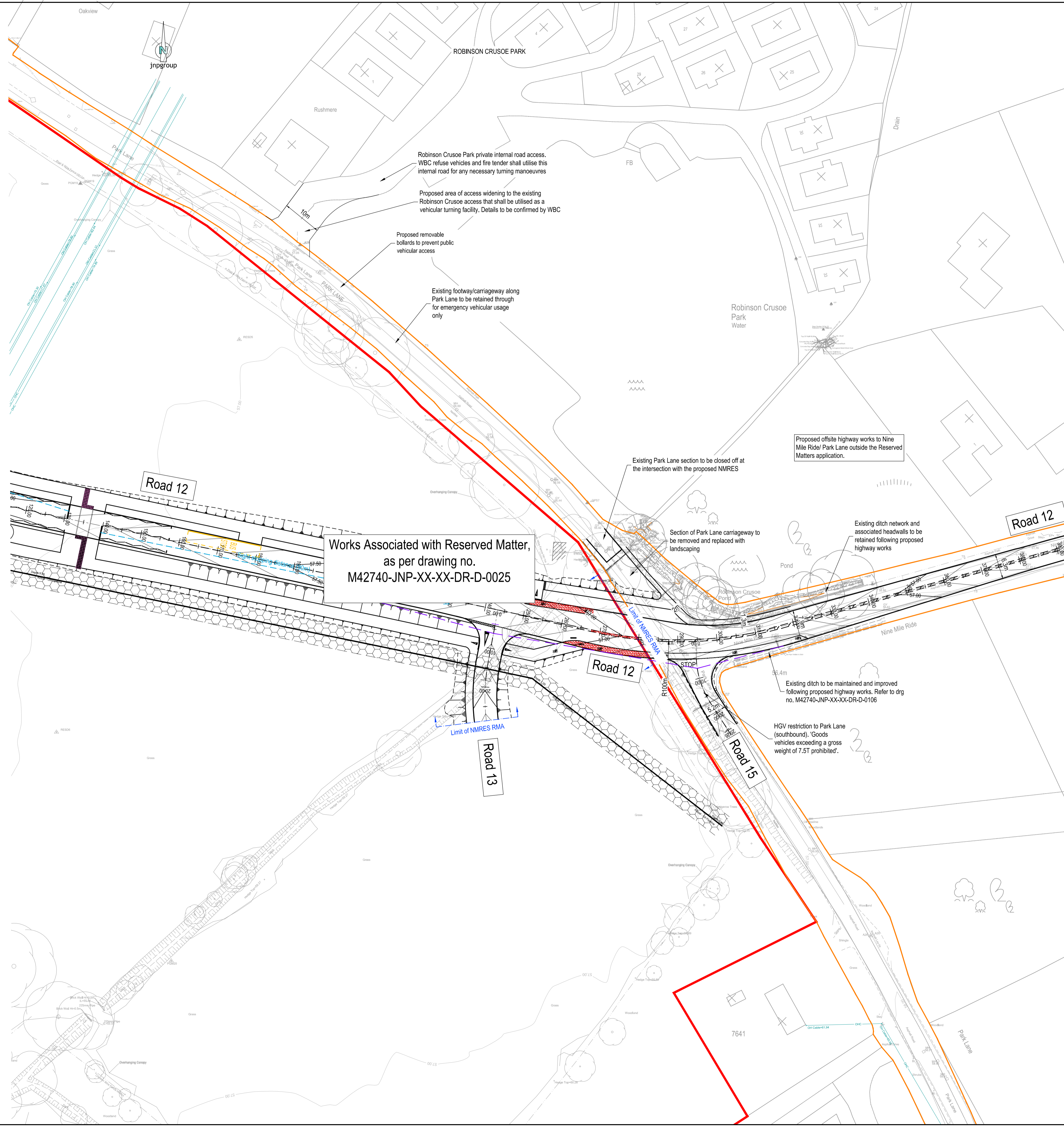

- General Notes**
1. Where this drawing has been issued in electronic .dwg format it has been done so in good faith. jnpgroup do not take any responsibility for any inaccuracies in the electronic data, which should be checked against the paper (or .pdf) drawing issue. Any apparent discrepancies should be immediately reported to jnpgroup. The electronic .dwg file should not be assumed to be to scale and should not be used for 'overlaying', setting out or checking of any third party information. All dimensions should be taken from the paper (or .pdf) version of the drawing. Electronic drawings may contain third party information. jnpgroup take no responsibility for this information, which should be checked against the originators paper drawing(s).
 2. All working dimensions to be checked on site.
 3. Do not scale.
 4. Any discrepancies between drawings of different scales, and between drawings and specification where appropriate to be notified to The Engineer for decision.
 5. Copyright reserved. This drawing may only be used for The Client and location specified in the title block. It may not be copied or disclosed to any third party without the prior written consent of jnpgroup.
 6. This drawing should only be used for construction if the drawing status is "Construction". jnpgroup take no responsibility for construction works undertaken to drawings which are not marked with this status.

Health & Safety Note

The details on this drawing have been prepared on the assumption that a competent contractor will be carrying out the works. If the contractor(s) considers that there is insufficient Health and Safety information on this drawing, this should immediately be brought to the attention of the designer.

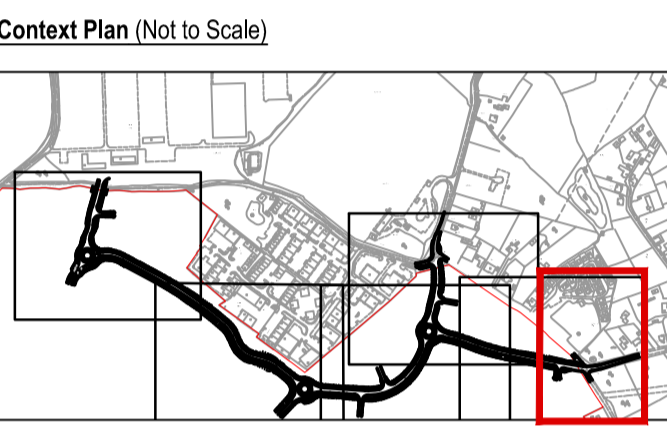

83

Offsite Works Notes

All works outside the site boundary are not a part of the Reserved Matters application and have been shown indicatively and as supporting information only.

CLH Oil Pipeline Notes

All works within or in proximity of the oil pipeline to be strictly in accordance with the pipeline operators requirements. All necessary permits to be obtained by the Contractor.

Line and level of existing CLH oil pipeline based on trial pit survey shown on the Topographical Survey by Brunel Surveys.

Utilities Notes

For all proposed utility alterations and and new supply works, refer to Triconnex design pack.

It is the Contractor's responsibility to liaise with all relevant services companies to ensure that all existing services are accurately located and adequately protected during construction.

Ecology Notes

At all gully grating locations adjacent full height kerbs (125mm upstand) are specified, the kerb shall be an ACO Wildlife kerb, or similar approved.

All gully pots shall have amphibian ladders installed to provide mammals and amphibians with a means of escape should they become trapped within the gully pot.

For full ecological mitigation recommendations and requirements, refer to the Outline Site-Wide Ecological Permeability Scheme by HDA, ref. 888.1, dated September 2018.

This drawing is based on the following information provided by others:

- Topographical Survey undertaken by Brunel Surveys Ltd, ref. 20318-500-01-Hogwood Farm 2D, dated 02/05/2019.
- OS Data: © Crown copyright and database rights 2016 Ordnance Survey 0100031673.
- Concept Masterplan (indicative only) by Cooper Baillie, ref. CB_12_103_A100 Rev L, dated April 2016.
- Arborfield Garrison NMRE North As-Built Survey, ref. A1577-3.5.2 Rev B, received 31/01/2019.

Works Associated with Reserved Matter, as per drawing no. M42740-JNP-XX-XX-DR-D-0025

Rev.	Date	Description	Drawn / Checked / App'd
B	23/09/2019	Updated for DFS 02 sign off	AK/SM/MT
A	06/09/19	Issued for RMA	SM/MT/MT

Submittal: S4 - Suitable for Stage Approval

Client Logo:

john newton & partners
jnpgroup
Consulting Engineers
www.jnpgroup.co.uk
Chesham • Brighouse • Hartlepool • Leamington Spa • Sheffield
Website: www.jnpgroup.co.uk

Client: Legal & General Homes

Job: Hogwood Farm, Finchampstead
Nine Mile Ride Extension

Title: Indicative Offsite Highway Works
Park Lane South

Classification:	FL_60_20	Scale @ A1:	1:500	Date Issued:	30/08/2019	Drawn / Ckg. / Chk / Tech. / Ckg.	SM /KT /KM
-----------------	----------	-------------	-------	--------------	------------	-----------------------------------	------------

Project - Originator - Volume/System - Level/Location - Type - Discipline - Number

M42740-JNP-XX-XX-DR-D-0070 B

Document/Drawing Number

This page is intentionally left blank